

BoscoLighting Brick Light Installation Instruction

Introduction

Thank you for choosing BoscoLighting products.

This document aims to guide a qualified installer or electrician in installing of this product to ensure correct function and safety. Note by Law, certain electrical works must be completed by a licensed electrician. Each State maintains their own licensing system, for more information see www.erac.gov.au/index.php?Itemid=516.

Warranty

Your BoscoLighting light fitting is covered by a 3 year warranty. Please retain proof of purchase or register your purchases by sending an email to warranty@boscolighting.com.au by attaching a copy of your purchase invoice, details of the end user (name, company, phone and address) and electricians company and electrical license number.

Warranty will be void if there is any damage due to improper installation, modification to the fitting except from the standard issued parts and features or used for purposes other than the intended purpose and safety precautions and warnings had been disregarded, site issues like voltage surges, vandalism or rodent damage.

Safety Instructions

- First and foremost, do not install or operate the fitting if it appears to be damaged in any way. Please inform your local supplier or send an email to warranty@boscolighting.com.au as stated on the warranty section of this document.
- Electrical connections and wirings must be carried out by a licensed electrician in conformance with the electrical standards.
- BoscoLighting brick lights are all rated with Ingress Protection 65 (IP65) which are weatherproof and designed for outdoor application. However, note that the lights are not designed to be installed on hazardous, corrosive, flammable areas or to be submerged underwater.
- Turn off the fuse/circuit breaker that controls the power to the area or fixtures that you are working on. Turn off as well the light switches on your wall and do not forget to test the electrical wires for voltage presence before you start working to avoid unexpected electrical shock.
- It may be permissible under local laws to install DC 12/24V lights yourself, however they do require a power supply adaptor (driver) which may require licensed electrician installation. Low voltage operation requires thicker cabling to prevent voltage drop and so licensed electricians may be required to determine wiring requirements of your location.
- Incorrect wiring, including incorrect polarity, incorrect gauge wires resulting in voltage drop, faulty connections or other excessive resistance being placed on the driver will result in reduced operating life of the product and will also invalidate our warranty. If in any doubt, get a licensed electrician even for low or extra low voltage lighting.
- AC240V models require licensed electrician installation.
- To power the brick light, please check current guidelines for wiring requirements. We also recommend proper insulation of cables and connections for DC24V fittings to ensure longer lifetime for light fittings and drivers.

- Please also refer to the voltage drop and wire sizing chart since it is important to choose the correct wire size for any specific application for it is dependent with the voltage drop, resistance, amperage rating and environment. Also use waterproof connectors for wiring which are rated for outdoor use if the application is outdoor.
- BoscoLighting brick lights are available in high or low operating voltages (AC240V or DC12/24V). It is however usually better to use low voltage DC 24V for safety and voltage drop prevention for outdoor applications.
- Use proper electrical protective gear and electrical tools during the installation.

Installation Instructions

STEP 1: Unscrew or pull out (some models uses clips to hold the light inside the canister) carefully the light itself from the canister, cut a hole on the wall as per the indicated cut-out dimensions of the brick light canister.

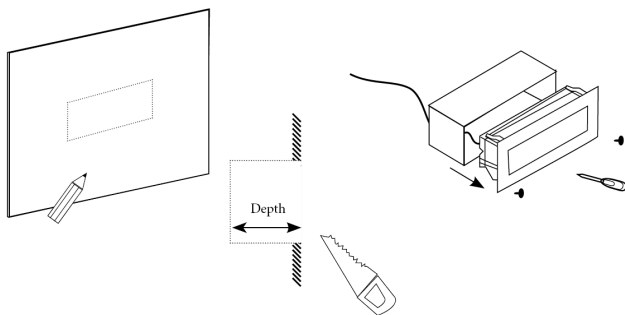

STEP 2: Screw in and fix the canister into the wall to hold it firmly in place, connect the electrical wirings to the light. You may need to use a heat shrink tube or any waterproofing connectors to prevent the wiring connection in contact with water if the application is outdoor. Again for your safety, please make sure that the supply cable power or switch has been properly turned off and no electrical voltage is present.

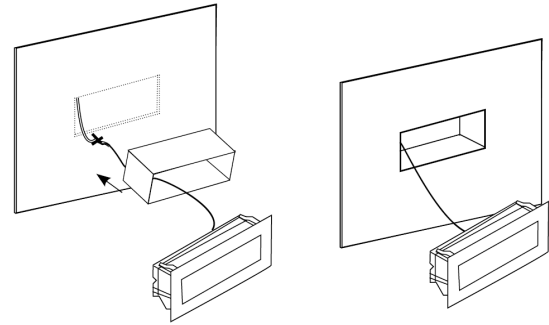

STEP 3: Once done, put back the light inside the canister by screwing it in or aligning the clips with the canister while gently pushing inward (Polyurethane foam sealing agent can be considered to use for permanent installation or security concern).

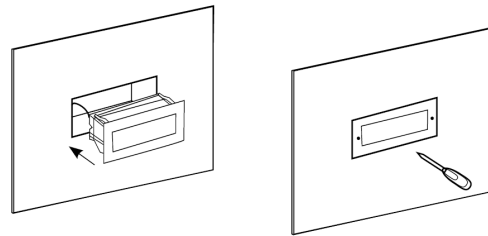

Maintenance

- Make sure that the power to the brick light has been turned off and has given the time to cool down after being used before you start of cleaning the lighting fixture. Cleaning must be done at interval schedules to ensure to have a better lighting.
- Use damp clean cloth to wipe the dirt that adhered to the light fitting. Never try to immerse the light fitting in water.
- Use static free gloves when cleaning the luminaire to avoid markings.

Disclaimers

- BoscoLighting is not liable where :
 - There is product malfunction and or any damages caused by improper use or installation.
 - Installation has not completed by licensed electricians.
 - Safety instructions have not been properly followed.
 - Damage due to site issues such as voltage surges, rodent damage or vandalism.
- Kindly be advised that the lights are not specifically designed to be installed on flammable, hazardous and or corrosives areas.
- Lights have been designed to operate at an ambient temperature of -10°C to 45°C. Usage outside of this range may have undesired effects including shortening of product life.
- Lights are only to be repaired under guidance of BoscoLighting, any damages resulting from unauthorised alterations or repairs is expressly not permitted and will result in BoscoLighting Warranties and Liability being void.
- Old style Rheostat dimmers are incompatible with LED products, warranty will be void if used on circuit with BoscoLighting products.
- BoscoLighting has the right to modify or obsolete the design of its products for quality improvement or due to supplier constraints.
- Products may appear different to product data sheets or installation instructions.