

BoscoLighting Trimless Extrusion Installation Instruction

Introduction

Thank you for choosing BoscoLighting products.

This document aims to guide a qualified installer or electrician in installing of this product to ensure correct function and safety. Note by Law, certain electrical works must be completed by a licensed electrician. Each State maintains their own licensing system, for more information see www.erac.gov.au/index.php?Itemid=516.

Warranty

Your BoscoLighting light fitting is covered by a 3 year warranty. Please retain proof of purchase or register your purchases by sending an email to warranty@boscolighting.com.au by attaching a copy of your purchase invoice, details of the end user (name, company, phone and address) and electricians company and electrical license number.

Warranty will be void if there is any damage due to improper installation, modification to the fitting except from the standard issued parts and features or used for purposes other than the intended purpose and safety precautions and warnings had been disregarded, site issues like voltage surges, vandalism or rodent damage.

Safety Instructions

- First and foremost, do not install or operate the fitting if it appears to be damaged in any way. Please inform your local supplier or send an email to warranty@boscolighting.com.au as stated on the warranty section of this document.
- Before installation, check the installation location if it has an access to a socket outlet which is connected to a wall switch. If it does not, a socket should be installed on a

- These trimless extrusions are rated with Ingress Protection 20 (IP20) which means they are suitable ONLY for all indoor dry applications such as offices, retail shops, bedrooms and living rooms. However, you can use an IP65 or IP68 rated LED strips and power supply to add protection against moisture for areas that get wet or overly humid, however this product is not designed for submersion under water, pressure water cleaning or steam cleaning.
- Turn off the fuse/circuit breaker that controls the power to the area or fixtures that you are working on. Turn off as well the light switches on your wall and do not forget to test the electrical wires for voltage presence before you start working to avoid unexpected electrical shock.
- Use proper electrical protective gears and electrical tools during the installation.

Installation Instructions

STEP 1: Cut hole into the plasterboard as per the required cut-out size and shape or provide a gap in between plasterboard or drywall fit for the extrusion. For inner or outer corner extrusions, place first the extrusion onto the corner and fix it in place using metal screws or mounting adhesives then cover the mounting frame with the drywall or plasterboard as shown in the below figures.

lighting circuit according to electrical standards by a licensed electrician.

(Outer Corner Extrusion)



(Inner Corner Extrusion)



STEP 2: Before fixing or putting the extrusion in place, make sure all LED strips or any required electrical cables had been installed already inside the extrusion. Otherwise, it may be quite difficult to place these LED strips and electrical cables inside the extrusion once it is already in place.

STEP 3: Connect the power cables onto the power supply socket and hide the power supply into the wall and fix the trimless extrusion in place using some metal screws to hold it in position or using plasterboard or drywall adhesives, let it dry.

STEP 4: Once dried, patch over the mounting frame with stucco or plaster and paint and let it dry to finish then install the diffuser.

Example Images:

(BLEX-TL002 installation)

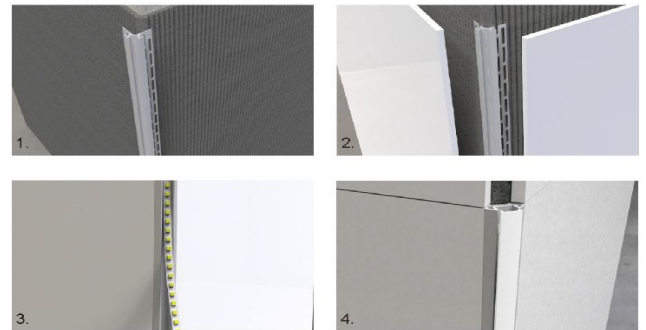

(BLEX-TL003 installation)

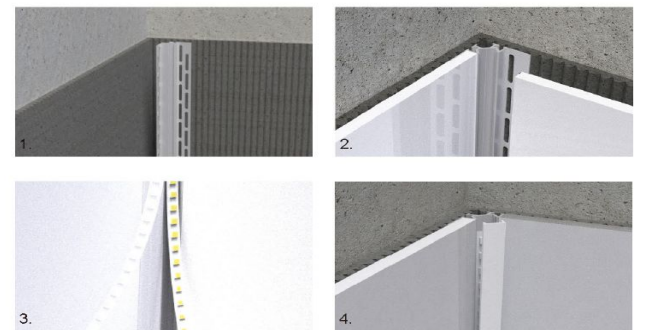

(BLEX-TL007 installation)

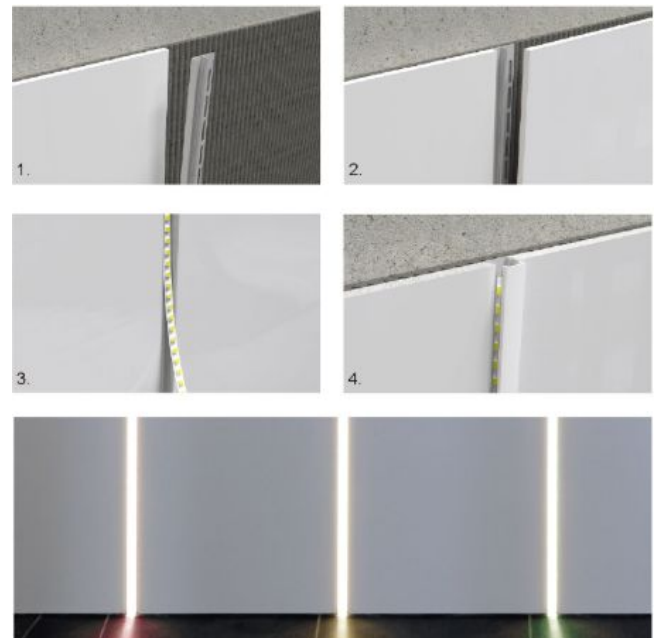

Maintenance

- Make sure that the power to the light fitting has been turned off and has given the time to cool down after being used before you start of cleaning the lighting fixture. Cleaning must be done at interval schedules to ensure to have a better lighting.
- Use damp clean cloth to wipe the dirt that adhered to the light fitting. Never try to immerse the light fitting in water.
- Use static free gloves when cleaning the luminaire to avoid markings.

Disclaimers

- BoscoLighting is not liable where :
 - There is product malfunction and or any damages caused by improper use or installation.
 - Installation has not completed by licensed electricians.
 - Safety instructions have not been properly followed.
 - Water or steam has entered the fitting.
 - Damage due to site issues such as voltage surges, rodent damage or vandalism.
- Kindly be advised that the lights are not specifically designed to be installed on flammable, hazardous and or corrosives areas.
- Lights have been designed to operate at an ambient temperature of -10°C to 45°C.
- Lights found out to be tampered with or have been tried to be repaired apart from the supplier/manufacturer during the warranty period shall void the warranty of the product. Hence, any damages caused by the said act will not be BoscoLighting's liability.
- BoscoLighting has the right to modify or obsolete the design of its products for quality improvement or due to supplier constraints.
- Products may appear different to product data sheets or installation instructions.

